

TRACETEK TT-PFT-3/4-MC, TT-PFT-3/4-SS/MC

PRESSURE FEED-THROUGH FITTING INSTALLATION INSTRUCTIONS

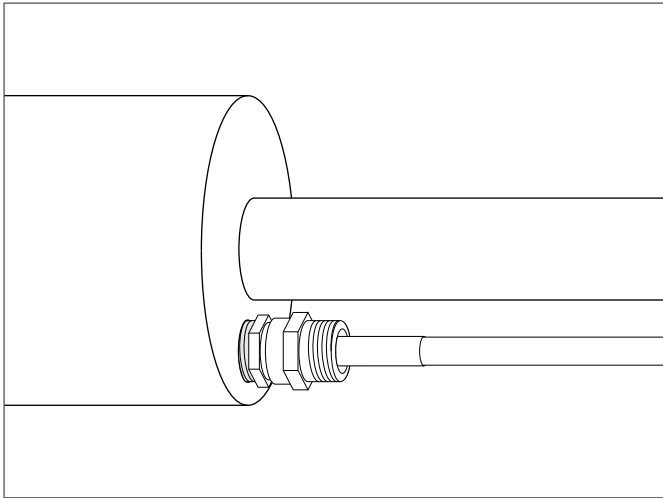

DESCRIPTION

The TraceTek TT-PFT-3/4-MC (brass) and TT-PFT-3/4-SS/MC (stainless steel) are feed-through fittings used to transition through containment systems. They are suitable for NEMA 4 environments and are rated for continuous exposure to 150 psi containment pressure.

TOOLS REQUIRED

- 12-inch adjustable wrench
- Heat gun (Ultratorch) or flameless heating tool

ADDITIONAL MATERIALS REQUIRED

- Teflon sealing tape

KIT CONTENTS

Item	Qty	Description
A	1	PFT body (non-containment side)
B	1	PFT nipple (containment side)
C	1	PFT bulkhead connector
D	2	Heat-shrinkable tube

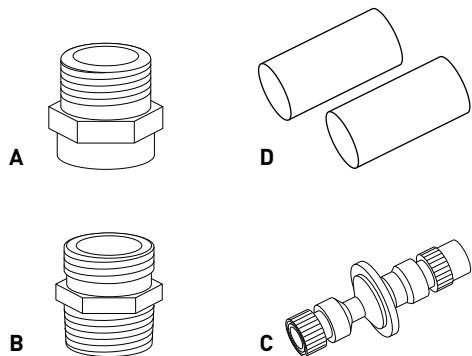

WARNING:

Overheating heat-shrinkable tubes will produce fumes that may cause irritation. Use adequate ventilation and avoid charring or burning. Consult MSDS RAY3122 for further information.

- Follow all installation instructions carefully.
- Do not use pipe dope, it may contaminate the sensing cable.
- Do not substitute kit parts.
- Investigate leaks immediately.
- In acidic environments, the TT-PFT-3/4-MC should be replaced in the event of a leak.

Note: Factory recommended mounting positions are top and side only

1

- Wrap Teflon tape around the 3/4 inch NPT thread of the PFT nipple. Be sure not to confuse the NPT threads with the coarser hose threads. Do not use pipe dope.

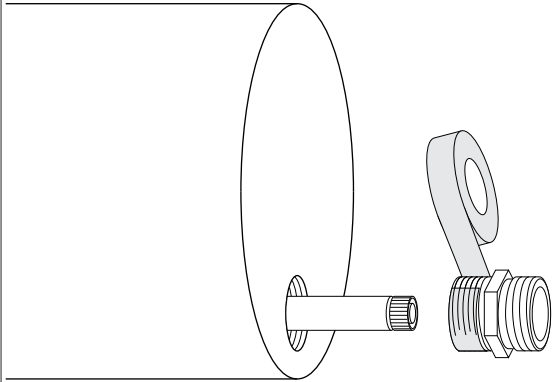

2

- Pull the end of the sensing cable out of the containment. Slip the PFT nipple over the sensing cable, NPT threads first. Using a wrench, tighten the PFT nipple into the threaded containment entry.

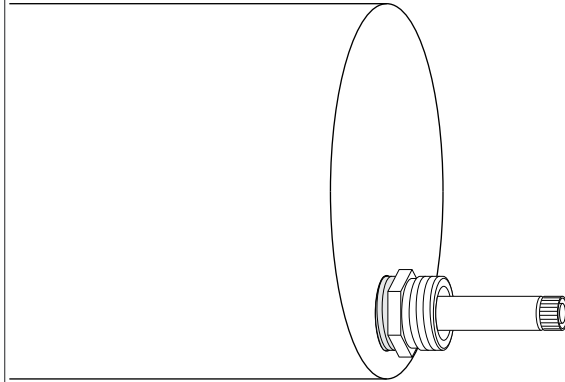

3

- Slip the heat-shrinkable tube over the sensing cable. Connect the sensing cable to the end of the bulkhead connector. NOTE: The bulkhead connector has both pin and socket ends. Use the end that mates to the sensing cable. (The bulkhead connector will fit into the PFT body in either orientation).

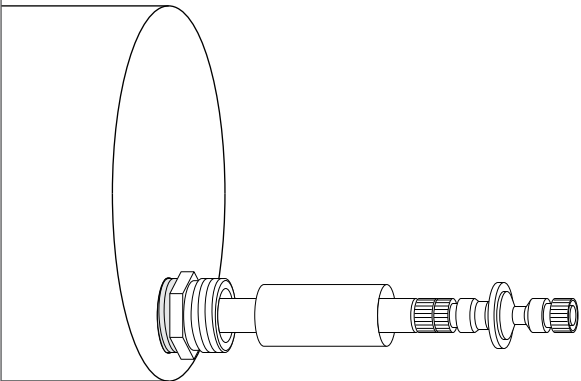

4

- Shrink the heat-shrinkable tube over the mated connectors using a flameless heating tool. Do not cover the large diameter area of the PFT bulkhead connector with the tube. Be careful not to burn the bulkhead connector body.

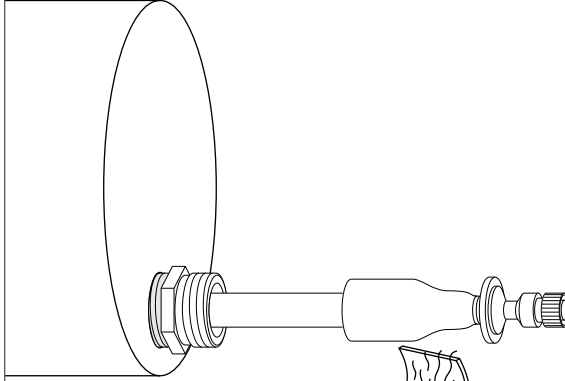

5

- Seat the bulkhead connector in the PFT nipple.

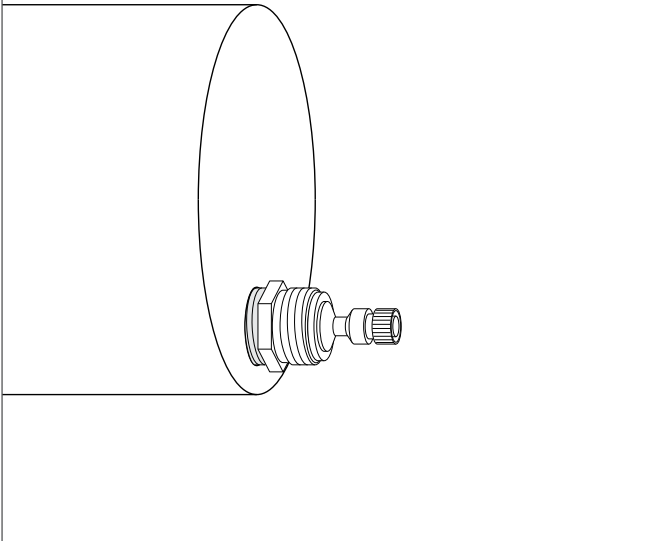

6

- Prepare the connecting jumper cable or sensing cable by slipping the PFT body over the connecting cable, NPT threads first. Slip the second heat-shrinkable tube over the connecting cable. Connect the outside cable to the bulkhead connector. Shrink the tube over the mated connection.

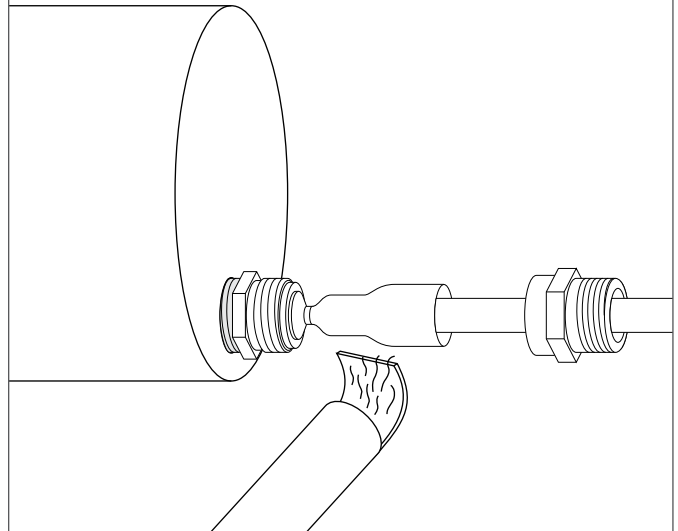

7

- Hand tighten the PFT body onto the PFT nipple. Finish tightening with a wrench 1/6 turn (do not over-tighten). Jumper cable to be installed per local codes. If a junction box is used, fasten the PFT body to the junction box with a 3/4 inch lock nut.

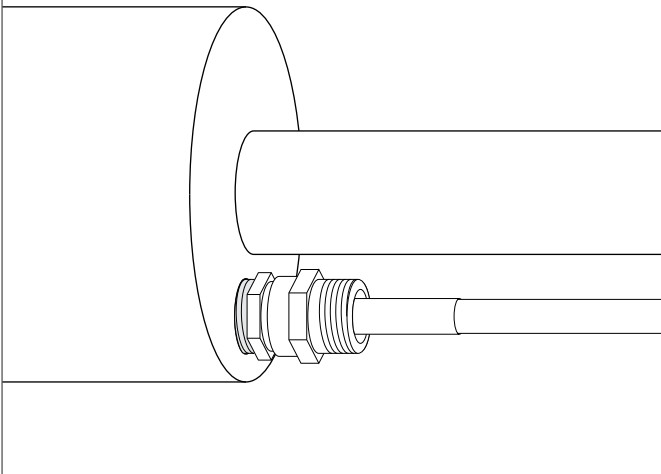



WWW.PENTAIRTHERMAL.COM

NORTH AMERICA

Tel: +1.800.545.6258
Fax: +1.800.527.5703
Tel: +1.650.216.1526
Fax: +1.650.474.7715
thermal.info@pentair.com

EUROPE, MIDDLE EAST, AFRICA

Tel: +32.16.213.511
Fax: +32.16.213.603
thermal.info@pentair.com

ASIA PACIFIC

Tel: +86.21.2412.1688
Fax: +86.21.5426.2937
cn.thermal.info@pentair.com

LATIN AMERICA

Tel: +1.713.868.4800
Fax: +1.713.868.2333
thermal.info@pentair.com

Pentair is owned by Pentair or its global affiliates. All other trademarks are the property of their respective owners. Pentair reserves the right to change specifications without prior notice.